

Product Category: Rigid Framing Connector

Product Name: SmartFrame® *NEW* UtilityAngle (with holes) SFUAH Patent Pending

Product Description:

UtilityAngles (SFUAH are commonly used for rigid connections that require a 90 degree angle. Products featured on this document are punched as shown for easy fastener installation.

Material:

54mil thickness - 16 gauge, 0.0566" design thickness.
 68mil thickness - 14 gauge, 0.0713" design thickness.
 97mil thickness - 12 gauge, 0.1017" design thickness.
 ASTM A1003 coating.

Available Lengths:

3.250", 5.250", 7.250", 9.250", 11.250"

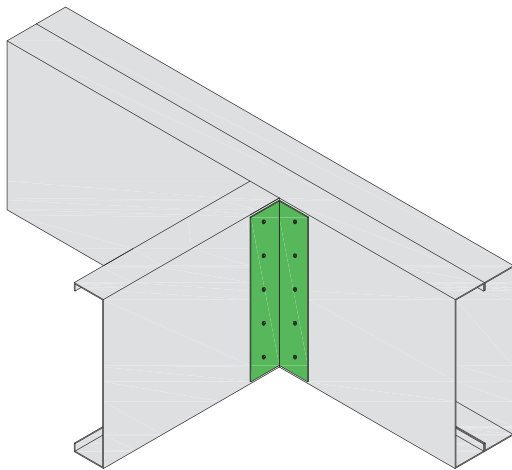

SFUAH1.5"x1.5"
 SFUAH1.5"x2"
 SFUAH2"x2"
 SFUAH3"x3"
 SFUAH4"x4"

SFUAH1.5"x3"
 SFUAH1.5"x4"
 SFUAH2"x3"
 SFUAH2"x4"
 SFUAH3"x4"

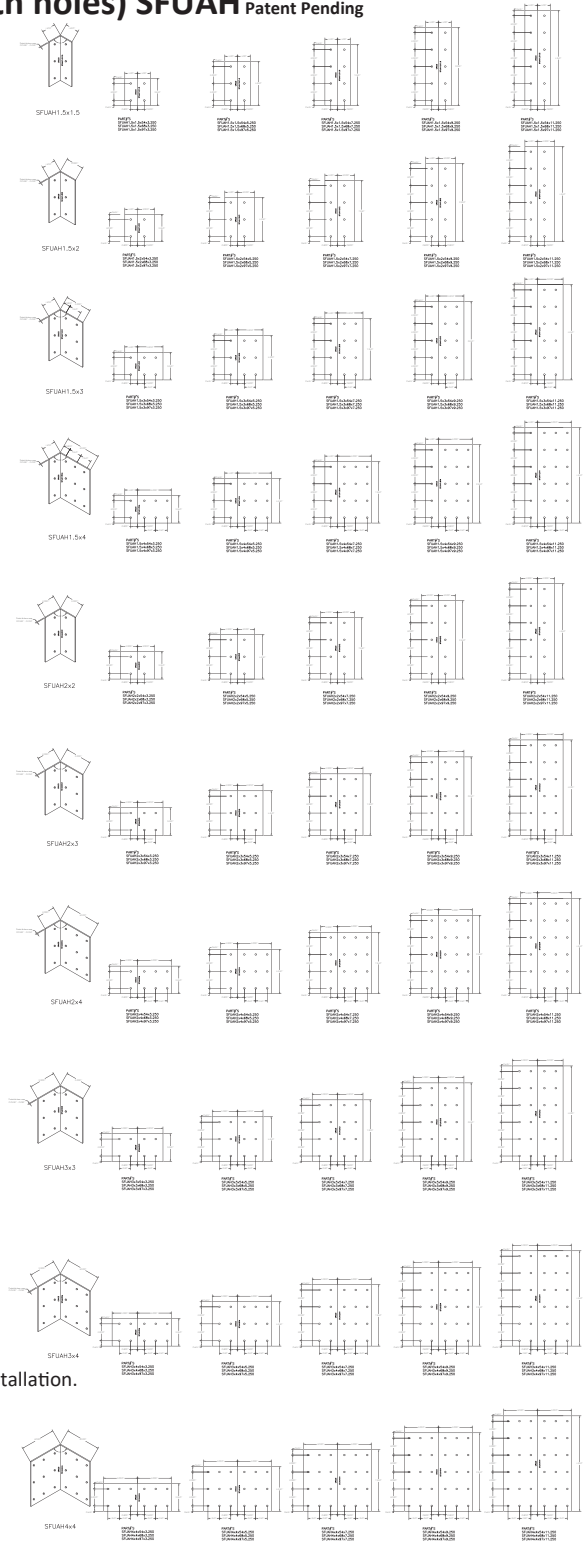

Notes:

1. Attach SmartFrame Connector to steel framing with #12 self-drilling screws.
2. It is the responsibility of the design professional to engineer and detail proper connector installation.
3. This document, dated 1/1/20, supercedes all previous versions.