

**Product Category:** Vertical Deflection Framing Connector  
**Product Name:** SmartFrame® WebFlex SFWF Patent Pending

**Product Description:**

WebFlex Connectors are used for securing steel studs to structure in a by-pass situation while simultaneously allowing for vertical deflection of the structure without the transfer of vertical loads.

WebFlex offers up to 1" of vertical movement in both up and down directions or up to 2" of vertical movement in one direction.

**Material:**

54mil thickness - 16 gauge, 0.0566" design thickness.  
 ASTM A1003 coating.

**Products:**

SFWF1200S  
 SFWF1200D

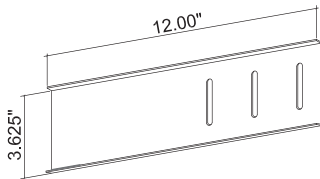

SFWF1200S

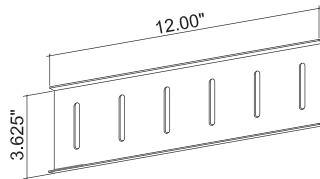

SFWF1200D

**SmartScrew**

by Grabber



Each SFWF comes with (2) SmartScrews  
 US Patent  
 US D643,279S

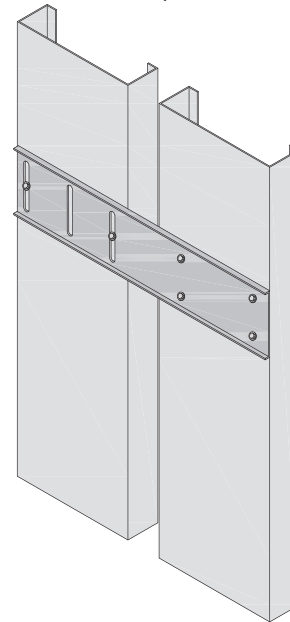
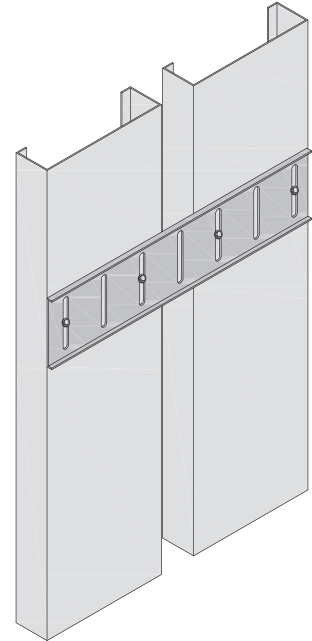

**Notes:**

1. Attach SmartFrame Connector to steel framing with #12 self-drilling screws and included #14 self-drilling "SmartScrews" by Grabber.
2. It is the responsibility of the design professional to engineer and detail proper connector installation.
3. This document, dated 7/1/17, supercedes all previous versions.